



ASTRE

Erasmus+ project. 2019-1-ES01-KA204-065644  
Automatic System for Tracking E-Learners

Co-funded by the  
Erasmus+ Programme  
of the European Union



# 01\_A8. TECHNICAL IMPLEMENTATION OF SURVEY TOOL IN ENGLISH. UPV

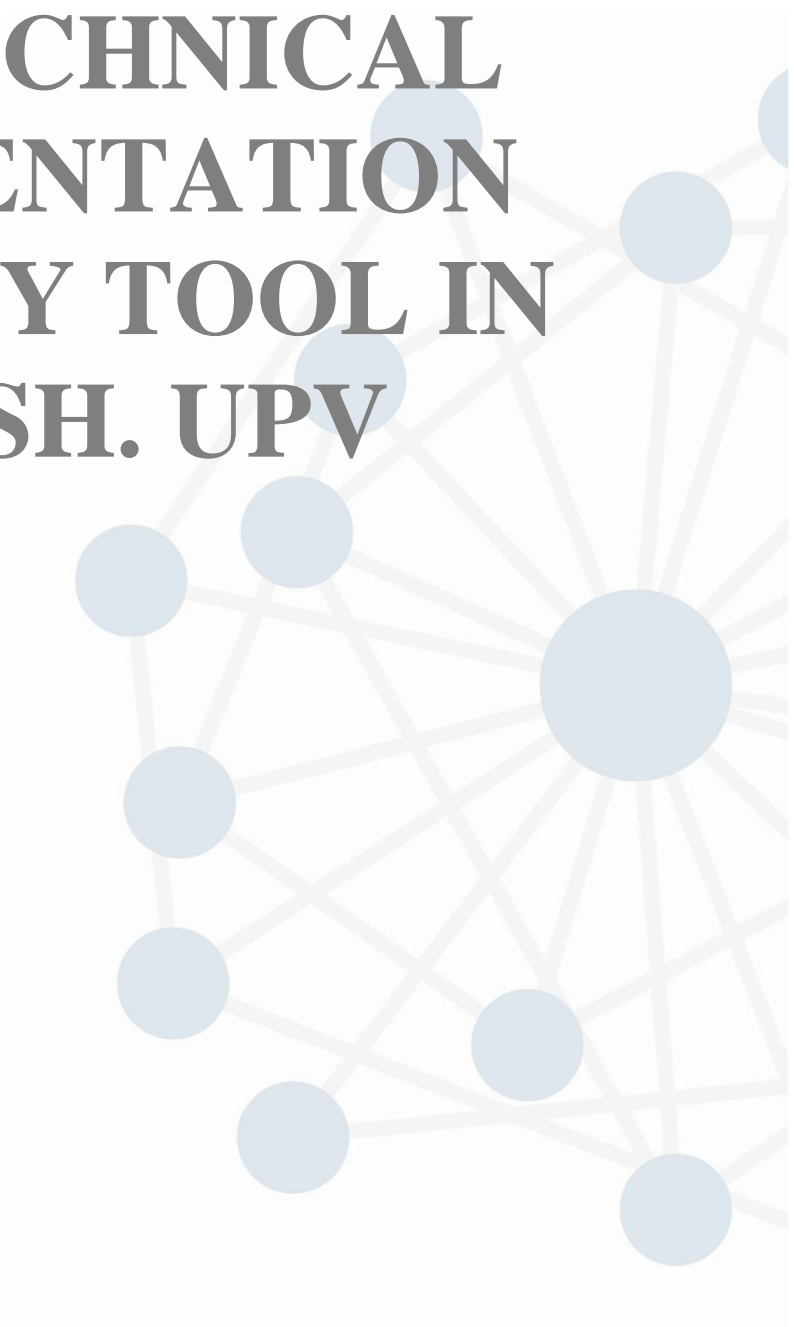



**Applicant Organisation:** UNIVERSITAT POLITECNICA DE VALENCIA, Spain

**Partners:**

FRIEDRICH-ALEXANDERUNIVERSITAET ERLANGEN NUERNBERG, Germany

European Association of Erasmus Coordinators, Cyprus

PANEPISTIMIO AIGAIYOU, Greece

IDEC, Greece

UNIVERSITA TELEMATICA PEGASO , Italy

@copyright 2019 IDEC

This document may not be copied, reproduced, or modified in whole or in part for any purpose without written permission from the author. In addition an acknowledgment of the authors of the document and all applicable portions of the copyright notice must be clearly referenced.

All rights reserved.



## Contents

<b>1. PRESENTING THE SURVEY .....</b>	<b>ERROR! BOOKMARK NOT DEFINED.</b>
INTRODUCTORY TEXT.....	<b>ERROR! BOOKMARK NOT DEFINED.</b>
DEFFINITIVE QUESTIONAIRE .....	3
<b>2. SURVEY UPLOADED IN PLATFORMS .....</b>	<b>6</b>
2.1.- EU SURVEY.....	6
2.2 GOOGLE FORMS.....	6
SURVEY PROTOCOL FOR GOOGLE FORMS (ENGLISH).....	7

### Presenting the survey

This survey has been defined as the core of the tracking system for improving the quality of offered online learning courses and its impact on egressed students. This survey will take you less than 10 minutes and can be really helpful for designing contents in future online courses. It is a result of ASTRE project (2019-1-ES01-KA204-065644 ), which is co-funded by the Erasmus + Program of the European Union.

Now you can start with questions:

### DEFFINITIVE QUESTIONAIRE

---

#### PERSONAL DATA

1. YEAR OF BIRTH
2. CITY AND COUNTRY OF RESIDENCE
3. GENDER  
 Male     Female     I prefer not to answer
4. LEVEL OF EDUCATION AT THE TIME OF ENROLMENT IN THE COURSE (REGARDLESS OF THE FIELD OF STUDY)  
 None     Elementary School     High School     Associate degree     Bachelor's Degree     Master's Degree

#### COURSE INFORMATION

5. LEVEL OF COURSE ATTENDED  
 Bachelor's Degree     Master's Degree     Master's Degree     Other
6. DID YOU OBTAIN THE TITLE/ACCREDITATION?  
 Yes     No
7. WHEN DID YOU OBTAIN THE TITLE/ACREDITATION?  
 0-6 Months ago     7-12 Months ago     13-18 months ago     19-24 months ago     more than 24 months ago
8. WHICH WAS THE TITLE OF THE PROGRAM



9. DID THE COURSE HELP YOU ENRICH YOUR PROFESSIONAL PROFILE?  
 Yes  No
10. HAVE YOU ENROLLED IN THE COURSE TO IMPROVE YOUR PROFESSIONAL CAREER OR TO FIND A FIRST OR NEW JOB  
 Yes  No

**E-LEARNING EVALUATION**

11. AT THE END OF THE COURSE, DID YOU ENROL IN ANOTHER ONLINE COURSE?  
 Yes  No
12. IF YOU ANSWERED YES TO QUESTION 11 - THE SECOND COURSE WAS AN ADVANCED COURSE, BUT WITHIN THE SAME SCOPE AS THE PREVIOUS ONE  
 Yes  No
13. IF YOU ANSWERED YES TO QUESTION 11 - THE SECOND COURSE WAS AN EQUAL LEVEL COURSE, BUT IN A DIFFERENT FIELD  
 Yes  No
14. IF YOU ANSWERED YES TO QUESTION 11 - WAS THE SECOND COURSE PROVIDED BY THE SAME INSTITUTION?  
 Yes  No
15. IF YOU COULD GO BACK IN TIME WOULD YOU REPEAT THE SAME COURSE?  
 Yes  No
16. ARE YOU INTERESTED IN ENROLLING IN A NEW ONLINE COURSE?  
 Yes  No

**WORKING STATUS AND REMUNERATION**

17. DID WAS THE CERTIFICATE OF THE COURSE MANDATORY TO CARRY OUT A SPECIFIC ACTIVITY IN YOUR JOB?  
 Yes  No
18. BEFORE COMPLETING THE COURSE WHAT WAS YOUR JOB POSITION?  
 Unemployed  Not permanent contract  Permanent contract  Freelance  Internship
19. BEFORE COMPLETING THE COURSE, WHICH WAS YOUR GROSS MONTHLY INCOME FROM YOUR JOB?  
 0  <5.000 €  5.000 -10.000 €  10.000-20.000 €  20.000-30.000 € e  > 30.000
20. ONE YEAR AFTER COMPLETING THE COURSE, WHAT WAS YOUR JOB POSITION?  
 Unemployed  Not permanent contract  Permanent Basis employment  Freelance  Internship
21. TWO YEARS AFTER COMPLETING THE COURSE, WHAT WAS YOUR JOB POSITION?  
 Unemployed  Not permanent contract  Permanent Basis employment  Freelance  Internship
22. ONE YEAR AFTER COMPLETING THE COURSE, WHAT WAS YOUR GROSS MONTHLY INCOME FROM YOUR JOB?  
 0  <5.000 €  5.000 -10.000 €  10.000-20.000 €  20.000-30.000 € e  > 30.000
23. TWO YEARS AFTER COMPLETING THE COURSE, WHAT WAS YOUR GROSS MONTHLY INCOME FROM WORK?  
 0  <5.000 €  5.000 -10.000 €  10.000-20.000 €  20.000-30.000 € e  > 30.000

Not compulsory to answer.

24. BEFORE COMPLETING THE COURSE IN WHICH SECTOR DID YOU WORK?  
 Private  Public
25. AFTER ONE YEAR COMPLETING THE COURSE IN WHICH SECTOR DID YOU WORK?  
 Private  Public



26. AFTER TWO YEARS FROM THE ACHIEVEMENT THE COURSE IN WHICH SECTOR DID YOU WORK?  
 Private  Public
27. IF YOU WERE ALREADY WORKING BEFORE YOU COMPLETING THE COURSE, DID YOU CHANGE YOUR AREA OF YOUR WORK?  
 Yes same sector  Yes Different sector  No
28. DID THE COURSE ALLOW YOU TO FIND A FIRST JOB?  
 Yes  No
29. DID YOUR COURSE HELPED YOU TO CHANGE YOUR JOB?  
 Yes  No
30. DID THE COURSE HELPED YOU TO GET A PROMOTION IN YOUR JOB?  
 Yes  No

### **SATISFACTION WITH THE COURSE**

31. SCORE YOUR SATISFACTION WITH THE COURSE IN RELATION TO THE KNOWLEDGE LEARNED  
(1 LOW - 6 HIGH).  
\_1 \_2 \_3 \_4 \_5 \_6
32. SCORE YOUR SATISFACTION WITH THE COURSE IN TERMS OF ENHANCING YOUR CRITICAL THINKING ON THE TOPICS COVERED  
(1 LOW - 6 HIGH)  
\_1 \_2 \_3 \_4 \_5 \_6
33. SCORE YOUR SATISFACTION WITH THE COURSE IN TERMS OF THE METHODS OF STUDY  
(1 LOW TO 6 HIGH).  
\_1 \_2 \_3 \_4 \_5 \_6
34. SCORE YOUR SATISFACTION WITH THE COURSE IN TERMS OF COURSE ORGANIZATION  
(1 LOW TO 6 HIGH).  
\_1 \_2 \_3 \_4 \_5 \_6
35. SCORE YOUR SATISFACTION WITH THE COURSE WITH REGARD TO THE CLARITY OF THE LEARNING MATERIAL  
(1 LOW - 6 HIGH)  
\_1 \_2 \_3 \_4 \_5 \_6
36. SCORE THE USEFULNESS OF THE KNOWLEDGE LEARNED DURING THE COURSE IN YOUR WORK PRACTICE  
(1 LOW - 6 HIGH).  
\_1 \_2 \_3 \_4 \_5 \_6
37. SCORE THE USEFULNESS OF E-LEARNING TO ACQUIRE KNOWLEDGE IN YOUR FIELD OF WORK  
(1 LOW - 6 HIGH)  
\_1 \_2 \_3 \_4 \_5 \_6
38. IN GENERAL, WHAT WOULD YOU CHANGE TO IMPROVE E-LEARNING IN YOUR FIELD OF WORK?
-



## 1. SURVEY UPLOADED IN PLATFORMS

### 2.1.- EU Survey

The survey for tracking the learners from MOOCS uploaded in the EU SURVEY platform can be found in the link:

- [https://ec.europa.eu/eusurvey/runner/ASTRE\\_Survey](https://ec.europa.eu/eusurvey/runner/ASTRE_Survey)

Save a backup on your local computer (disable if you are using a public/shared computer)

#### ASTRE\_Survey

Fields marked with \* are mandatory.

**Disclaimer**

*The European Commission is not responsible for the content of questionnaires created using the EUSurvey service - it remains the sole responsibility of the form creator and manager. The use of EUSurvey service does not imply a recommendation or endorsement, by the European Commission, of the views expressed within them.*



Co-funded by the  
Erasmus+ Programme  
of the European Union



### 2.2 Google Forms

The survey for tracking the learners from MOOCS uploaded in the Google Forms platform can be found in the link:

[https://drive.google.com/drive/folders/1rss0JUrJAAqg\\_0iaOETQ9sAWXTonVdKN?usp=sharing](https://drive.google.com/drive/folders/1rss0JUrJAAqg_0iaOETQ9sAWXTonVdKN?usp=sharing)





# ASTRE

## ASTRE

Erasmus+ project. 2019-1-ES01-KA204-065644  
Automatic System for Tracking E-Learners

### OBJECTIVE OF SURVEY

This survey has been defined as the core of the tracking system for improving the quality of offered online learning courses and its impact on egressed students. This survey will take you less than 10 minutes and can be really helpful for designing contents in future online courses. It is a result of ASTRE project (2019-1-ES01-KA204-065644 ), which is co-funded by the Erasmus + Program of the European Union.

Now you can start with questions:

#### A) PERSONAL DATA

1. YEAR OF BIRTH

## SURVEY PROTOCOL FOR GOOGLE FORMS (English)

One of the survey formats that the ASTRE website contains has been designed using the Google Forms tool. In order to use it, you must generate a copy that you can edit and modify or keep in the designed format.

It is an essential requirement to have a Google account to be able to save the survey form in your Google Drive space.

You can **request access** to the survey model by sending an email to the following address.

For GOOGLE FORMS

astregforms@gmail.com if you want to work with google forms in English



The ASTRE manager will send a link to your email that will give you access to the survey.

Once the link has been received, carry out the following operations to download a copy that you will host in your Google Drive space:

- 1) By linking to the link, the browser will send you to the survey prepared for you



martes, 19 de enero de 2021, 14:18

[Mostrar detalles](#)

[https://docs.google.com/forms/d/1ZJ7vnLF32KDPgJCC2-7e7HvFtPH1JFdgqYtEW\\_L8nBU/edit?usp=sharing](https://docs.google.com/forms/d/1ZJ7vnLF32KDPgJCC2-7e7HvFtPH1JFdgqYtEW_L8nBU/edit?usp=sharing)



The screenshot shows a Google Forms interface for a survey titled 'ASTRE'. At the top left, it says 'ASTRE 2021' with a folder icon and a star. On the right, there are icons for chat, eye, settings, a 'Send' button, and a user profile icon. Below the title bar, there are tabs for 'Questions' and 'Responses'. The main content area has a header with the ASTRE logo and title. Below that is a text box with the project name and ID. The next section is 'OBJECTIVE OF SURVEY' with a paragraph of text. At the bottom, it says 'A) PERSONAL DATA'. On the right side of the form, there is a vertical toolbar with icons for adding, deleting, and other actions.

- 2) At the top right of the screen, click the icon  which will give you access to the following dropdown:





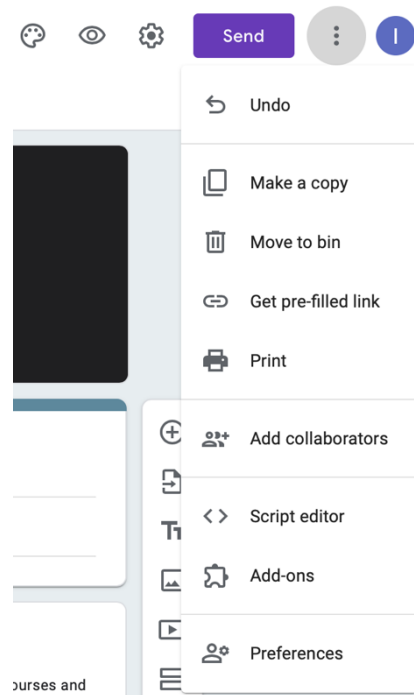

- 3) Click on in order to get a copy of the survey

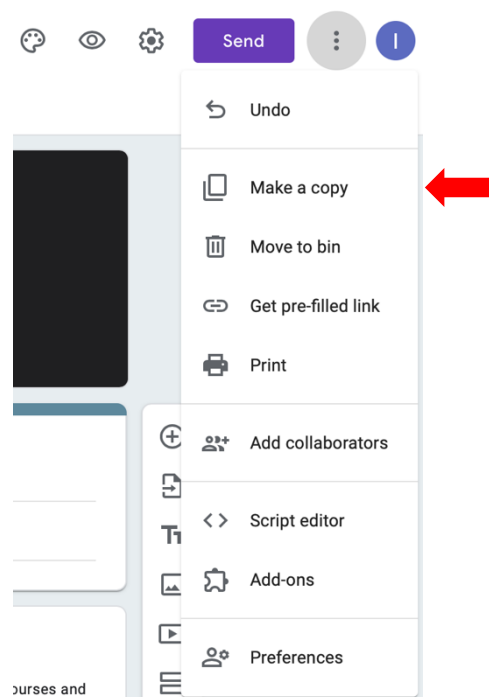

- 4) A pop-up window will open asking for a file name and the location within your Google Drive space where you want to save your survey



Copy document ✕

Name

Folder

Share it with the same people

You already have your survey format that you can maintain or modify / adapt to your needs.

**Notice that the link will be active in a period of time no longer than 48 hours from the receipt of the access link, after this period of time the original format will be eliminated and you will not be able to access the survey format, having to request a new access.**